

# CAR-NAVIGATION UNIT CONSTRUCTION

B3E092066902T02

## Structure

- The car-navigation unit is located in the glove compartment.
- An eject button, to eject the DVD-ROM from the loading slot, is included in the unit.
- A gyro sensor which detects vehicle cornering angle is built into the unit.

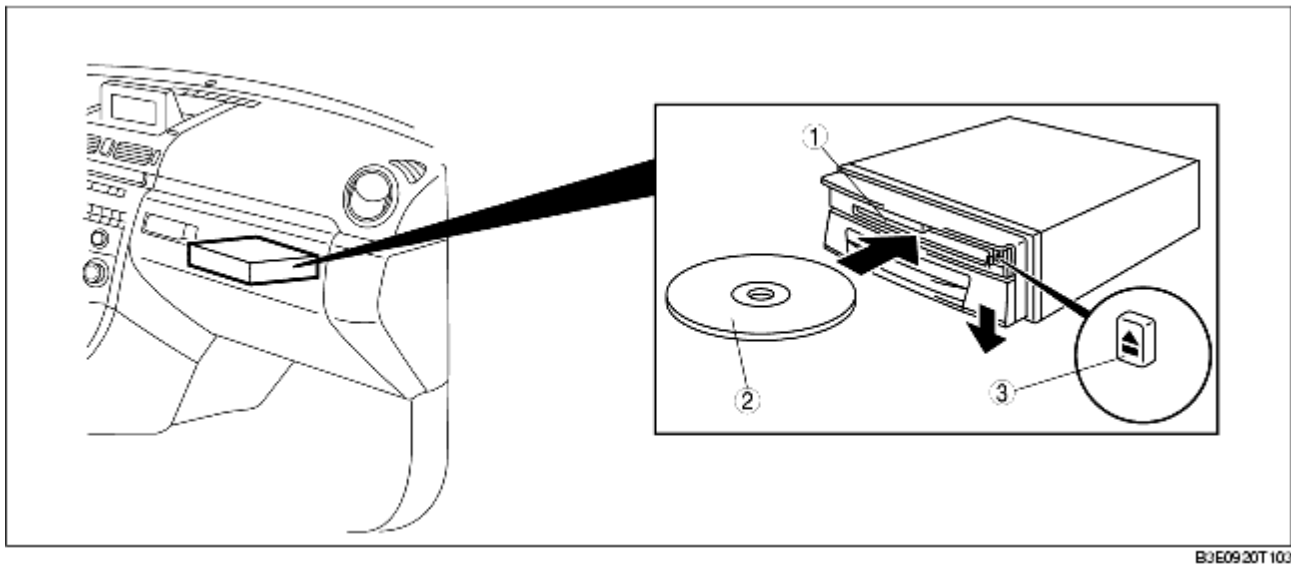

B3E0920T103

1	DVD-ROM loading slot
2	DVD-ROM
3	Eject button

## Terminal Layout and Signals

Terminal	Signals	
	16-pin connector	
	1A	GND
	1B	B+
	1C	-
	1D	ACC
	1E	PR front speaker input (-)
	1F	Illumination (-)
	1G	PR front speaker input (+)
	1H	Vehicle speed
	1I	PR front speaker output (-)
	1J	Parking brake switch

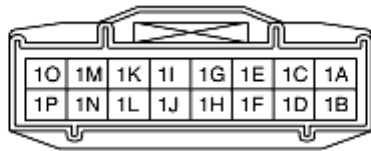

1K	PR front speaker output (+)
1L	R-range
1M	Front speaker output (-)
1N	Front speaker output (+)
1O	Front speaker input (-)
1P	Front speaker input (+)

Terminal	Signals	
	24-pin connector	
	2A	-
	2B	-
	2C	-
	2D	-
	2E	-
	2F	-
	2G	-
	2H	-
	2I	-
	2J	-
	2K	-
	2L	-
	2M	-
	2N	Monitor serial input
	2O	Shield GND
	2P	Monitor serial output
	2Q	Shield GND
	2R	Video (composite sync)
	2S	-
	2T	Video (B)
	2U	Video GND
	2V	Video (G)
	2W	-
	2X	Video (R)

Terminal	Signals	
	8-pin connector (for extended function)	
	3A	-
	3B	Serial output
	3C	-
	3D	Serial input
	3E	Power
	3F	Reset
	3G	B+
	3H	GND

Signal

Terminal		1-pin connector
	4A	GPS antenna input